



IT'S YOUR SPACE...



VAN DER VALK

BEACHCLUB 660 Flybridge



VAN DER VALK - Shipyard has been constructing both steel and aluminium motor yachts since 1967. The family-owned shipyard employs more than 45 craftsmen and is located in Waalwijk, the Netherlands. Its founder Mr. Wim van der Valk is still a driving force behind the company. The yard has primarily earned its worldwide reputation from the award-winning semi-custom Continental series. VAN DER VALK also has the capacity to build fully custom designs.

THE VALUES OF...
VAN DER VALK

Van der Valk owes its success over the years to an unwavering dedication to values such as reliability, cooperation and a forward-thinking approach. These apply to every aspect of who we are, what we do and the motoryachts we produce.

As a family-run concern with a pedigree that spans generations, Van der Valk understands the value of keeping your word and creating yachts that stand the test of time. We consider our partners and buyers to be family members too - and this is reflected in our excellent relationships and many repeat clients.

The creatives at Van der Valk work with owners to establish the best possible

solutions for their needs, and continue the partnership after delivery with a first-class after-sales service. Our lines of communication are short and our organisational structure flat. Relationships with co-makers - designers, engineers and suppliers - revolve around long-term partnerships and superior products.

Van der Valk always aims to apply the most advanced solutions, systems and materials possible within the available budget. During the engineering process, choices are made together with the owner and in consultation with the relevant suppliers, guaranteeing optimal results and maximum client satisfaction.

OUR YARD IN WAALWIJK, AN HOUR SOUTH OF AMSTERDAM, HAS FIVE STATE-OF-THE-ART PRODUCTION HALLS





VAN DER VALK
BEACHCLUB

The Van der Valk BeachClub line provides an unrivalled amount of exterior and interior space by locating the engine room in the same area as the swimming platform.

The 20.50-metre BeachClub 660 Flybridge is the second in this innovative range of motoryachts and will pioneer the incredible degree of spaciousness on offer.

WELCOME TO THE BEACH
SIDE OF LIFE





A NEW KIND OF SPACE WITH THE
VAN DER VALK BEACHCLUB

VAN DER VALK
BEACHCLUB

A new kind of space

The Van der Valk BeachClub has been developed in partnership with designer Cor D. Rover and Ginton Naval Architects. Our aim was to give not only an unprecedented feeling of space but far more space in reality. In our opinion too many yacht concepts are focussed on either the exterior or interior volume - the Van der Valk BeachClub optimises both.

"We achieved this by dispensing with the normal engine room and placing the revolutionary Volvo Penta IPS propulsion system (of which the Van der Valk shipyard

has successfully installed approx. 90 units) in the swimming platform area, where the height is still around 1.6 metres. This, by patent protected, arrangement makes the most of an aft area of the vessel that is rarely used, freeing up a great deal of volume for interior and exterior facilities. As a result the BeachClub line has the same amount of space that is usually found on far bigger yachts."



THE VAN DER VALK BEACHCLUB SERIES
DAZZLE INSIDE AND OUT WITH THEIR
STREAMLINED APPEARANCE AND SUPERIOR
TECHNOLOGY



VAN DER VALK
BEACHCLUB

Making the most of space

The BeachClub line will be offered in a range starting from 62 ft (19.05 metres). The second in the range, the all-aluminium BeachClub 660 (20,50 metre) is driven by a twin Volvo Penta IPS-1050 drive train boasting a top speed of approximately 26 knots.

The BeachClub 660 Flybridge will feature four main outdoor zones to optimise the "al fresco" lifestyle that many Van der Valk

owners enjoy. The enormous foredeck area spans some 25 square metres and offers various layout options, including fitting a Jacuzzi. There is a 17-square-metre cockpit deck with an outside steering position and a 10-square-metre flybridge. Last but not least, the beach club aft offers a sun lounge area within its 17 square metres.

LIGHT AND BRIGHT

The overall roomy ambience is further enhanced by the liberal use of glass, with all-round views from the two lounges and the master suite. There are also various glass inserts in the hull, giving an additional air of class to an exterior profile which exudes modern elegance.





VAN DER VALK
BEACHCLUB

The interior of the BeachClub line also makes the most of the possibilities which this new way of design thinking opens up. The forward owner's suite is a fabulous place and there are two separate saloons on the yacht. The spacious upper lounge has an inside steering position and panoramic views while the huge lower deck lounge includes a galley and dining area, all with direct access to the swim platform via curved glass sliding doors.

The overall roomy ambience is further enhanced by the liberal use of glass, with all-round views from the two lounges and the master suite. There are also various glass inserts in the hull, giving an additional

air of class to an exterior profile which exudes modern elegance.

Mini revolution

The Van der Valk BeachClub 660 Flybridge represents a mini-revolution in motoryachting. As well as offering a true innovation in terms of space, the yacht is completed to the highest standard of Dutch quality and detail. Contact us today if you are potentially interested in being part of something very special.



OUTDOOR LIFE

The BeachClub 660 Flybridge features four main outdoor zones to optimise the “al fresco” lifestyle that many Van der Valk owners enjoy:

- An enormous foredeck area spans some 25 square metres and offers various layout options, including fitting a Jacuzzi.
- The 17-square-metre cockpit deck is an impressive and comfortable location.
- The 10-square-metre flybridge deck offers great views and includes an outside steering position.
- The beach club aft features a smart swimming platform and a sun lounge area within its 17 square metres.





EXPAND YOUR LIVING SPACE WITH THE OUTDOOR SPACES, DESIGNED SPECIFICALLY FOR YOUR LIFESTYLE.



ENTERTAIN ON THE SUMMER DAYS. RELAX IN THE COOL SPRING AIR AND ON PERFECT AUTUMN EVENINGS.



THE BEACHCLUB'S FLY-BRIDGE AREA OFFERS GREAT VIEWS



YOUR PLACE FOR FAMILY AND FRIENDS TO COME TOGETHER TO RELAX AND CONNECT



THE BEACHCLUB'S OWNER'S AREA IS AN EXERCISE IN LUXURY



THE FORWARD MASTER STATEROOM IS A FABULOUS PLACE WITH A LOT OF NATURAL DAYLIGHT



THE BEACHCLUB 660 FLYBRIDGE ALSO OFFERS TWO TWIN CABINS



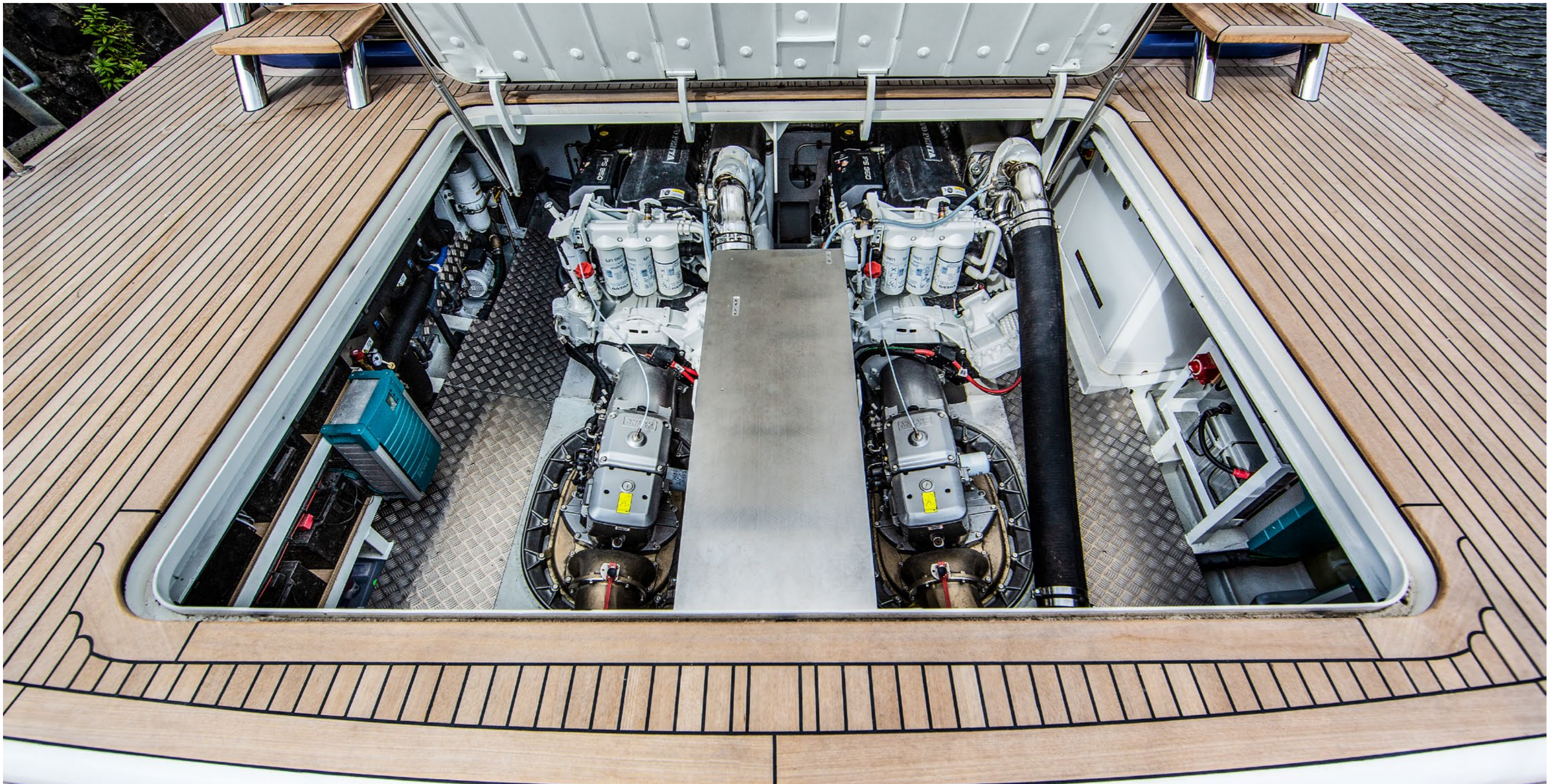

THERE IS SPACE FOR A LARGE TENDER ON THE SWIMPLATFORM THAT CAN BE LAUNCHED WITH A COMPACT TENDER DAVIT.



THE ENGINE ROOM IS LOCATED INSIDE THE SWIM PLATFORM

ALTERNATIVE INTERIOR DESIGN

As with any VAN DER VALK you have full freedom in designing (or determining) your own very personal layout (general arrangement), interior design, style, materials and finishes.

For example this "Mallorca" interior style with lacquered wood elements and white washed European Quercus Robur oak wood.



BEACHCLUB 66o Flybridge



ARRANGEMENT



PROFILE

VESSEL'S PARTICULARS

Certification	CE Class A
Exterior Design	Cor D. Rover
Interior Design	Cor D. Rover
Naval Architecture	Ginton Naval Architects

Main dimensions

Length over all	20,50m	(67'3ft)
Length waterline	20,10m	(65'11ft)
Beam	5,80m	(19'03ft)
Draft	1,50m	(4'11ft)
Displacement	38.000kg	(83775lbs - est.)

Construction / Machinery

Hull Material	Aluminium (AlMg4.5Mn - H321)
Superstructure material	Aluminium (AlMg4.5Mn - H111)
Hull shape	Moderate "V" - Hard chine
Engine brand & type	2x Volvo Penta D11B2-A MP 10,8l 6 cyl.
Engine HP	725hp / 533kW @ 2.500 rpm
Shaft/Propeller	IPS-950 (IPS2) drive units
Gear ratio	Reduction 1,70:1
Top speed	26 knots (est.)

Tank capacity

Fuel capacity	4000ltr	(1056 US gal.)
Fresh water capacity	750ltr	(198 US gal.)
Holding tank capacity	500ltr	(132 US gal.)

Arrangement

Accommodation	1 owner's cabin, 2 twin guest cabins
Crew	1 person crew, 1 cabin (optional)

Available spaces 67ft (20,50m) version

Outside	Inside
17m2 (183 ft2) Cockpit deck	21m2 (226 ft2) Wheelhouse
17m2 (183 ft2) Swim platform	30m2 (322 ft2) Lower saloon
25m2 (269 ft2) Front deck	44m2 (473 ft2) Accommodation deck
10m2 (107 ft2) Flybridge deck	

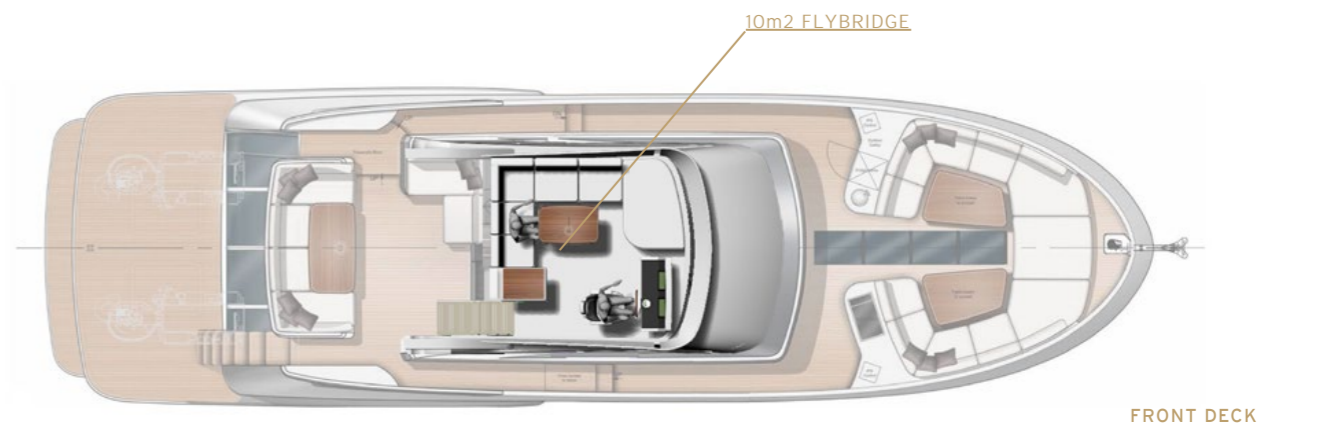

FRONT DECK

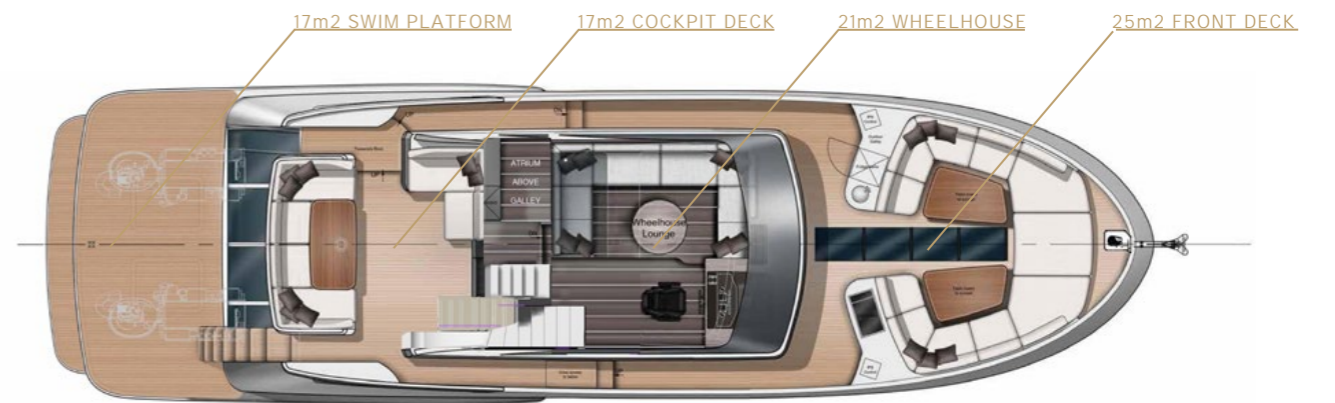

MAIN DECK

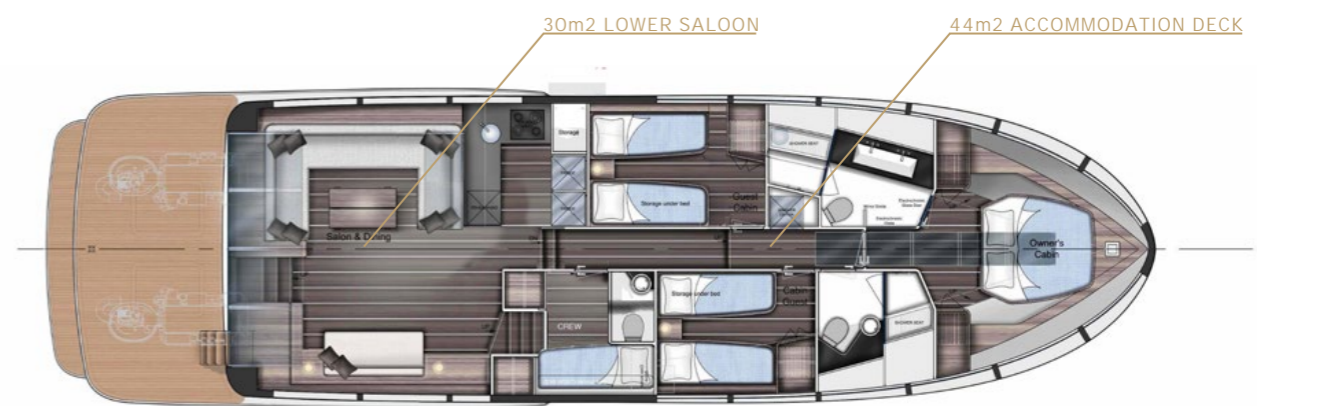

LOWER DECK

FRONT DECK OPTIONS

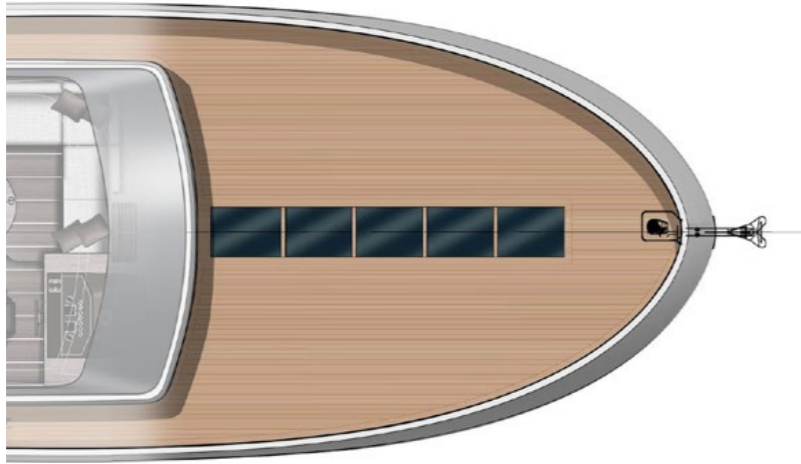

FRONT DECK – OPTION A

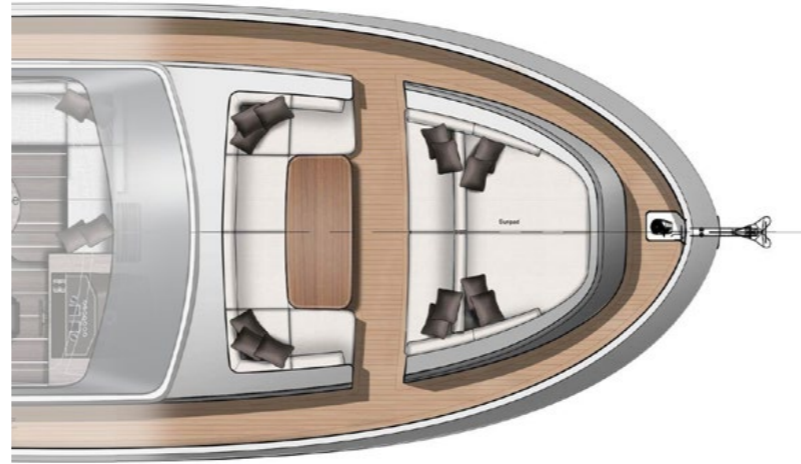

FRONT DECK – OPTION B

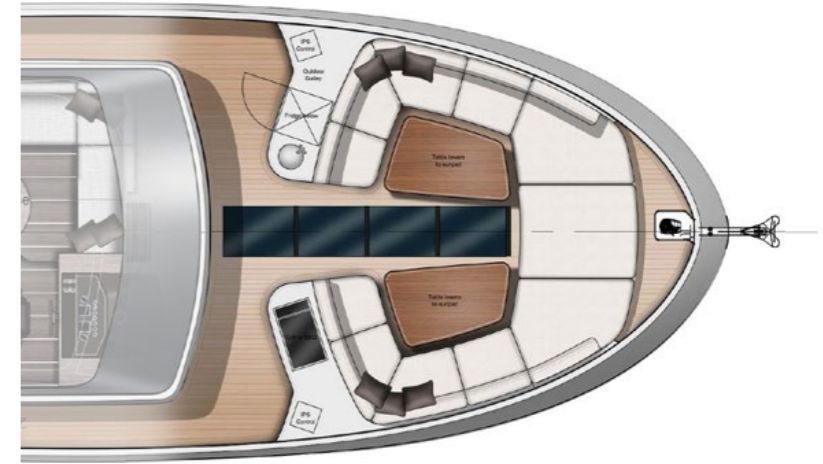

FRONT DECK – OPTION C

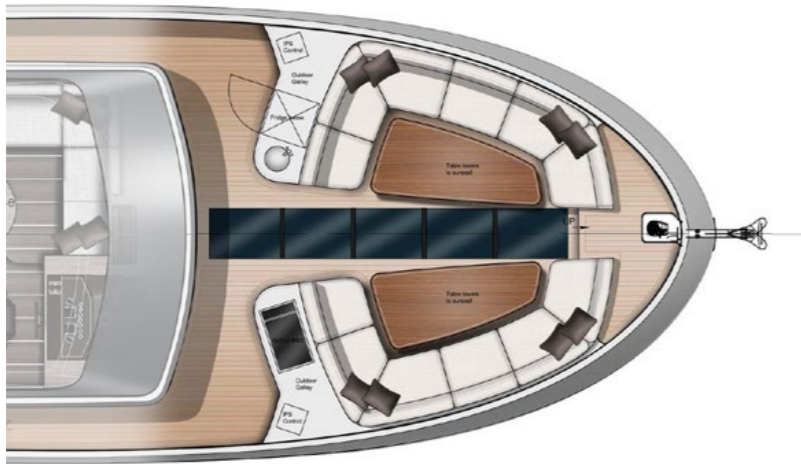

FRONT DECK – OPTION D

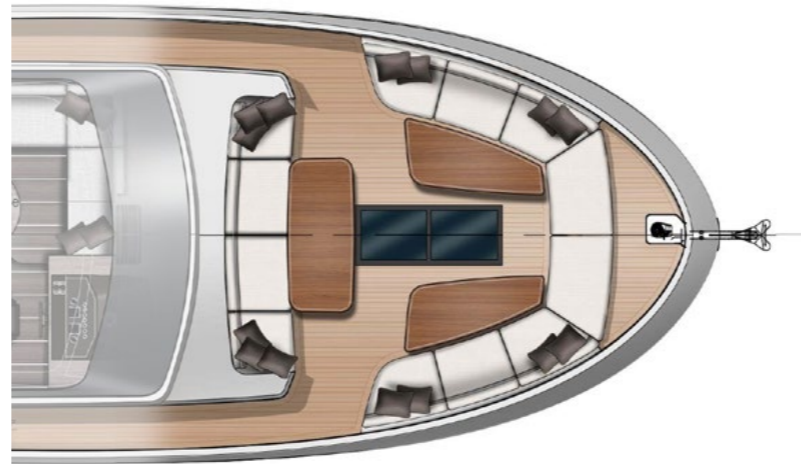

FRONT DECK – OPTION E

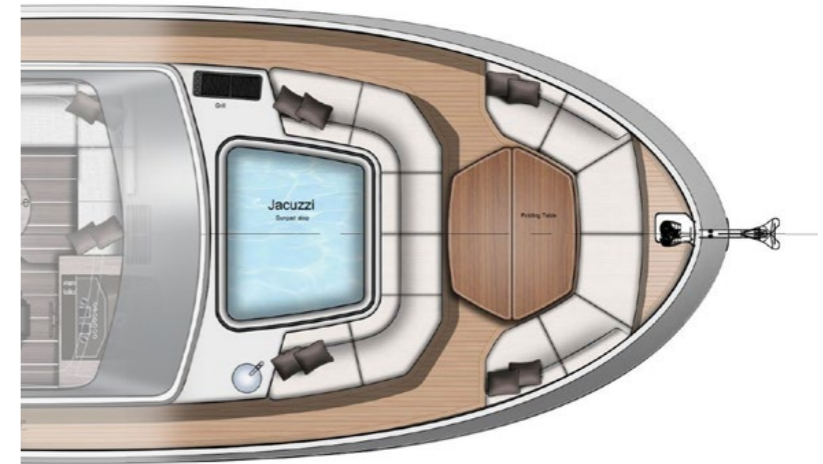

FRONT DECK – OPTION F



Speak to a Specialist



Email our Team



BeachClub 660 Mini-site



VAN DER VALK
BEACHCLUB

© 2019 Van der Valk Shipyard | All designs and specifications are subject to change without notice, due to modifications or improvements. No rights can be derived from the content of this brochure.